



GFE-MCPE-AI-IP67

ADDRESSABLE MANUAL CALL POINT OUTDOOR USE - IP67



The GFE-MCPE-AI-IP67 is an Analogue Addressable Manual Call Point, designed and manufactured to comply with EN54-11, compatible with all GFE Addressable Control panels specially recommended for outdoor use.

With its enhanced communications mechanism, the typical response time, when in alarm, is approximately one second, depending on the number of call points connected to the device loop. The individual address, up to 125, of each call point is set via an eight way DIL switch. Each unit is supplied, as standard, with a loop short circuit isolator. A bi-colour LED flashes Green when the unit is interrogated by the control panel and is illuminated Red when in alarm.

The GFE-MCPE-AI-IP67 has been designed to deal with today's difficult and harsh environments. It is a unique fire alarm manual call point that mimics the feel of breaking glass whilst offering the user the benefits and safety advantages of a glass-free resettable operating element. Once activated a warning flag drops in to view, easily identifying the call point that has been operated. A key can then reset the unit.

The GFE-MCPE-AI-IP67 provides an ideal solution for GFE's addressable fire alarm systems. Ideal for all outdoor applications such as oil rigs, ships, factories as well as wash down areas that are sensitive to broken glass.

TECHNICAL SPECIFICATIONS

OPERATION VOLTAGE	Loop Powered 20V to 30V DC
CURRENT - QUIESCENT	650 uA
ALARM	3.5 mA
OPERATION TEMPERATURE	-10°C to +55°C
STORAGE TEMPERATURE	-30°C to +60°C
PROTECTION	IP67 - Type A - Outdoor Use
CABLE SIZE	0.5-1.5 mm ²
MAX. HUMIDITY	95% RH Non-Condensing @ 40°C
COLOUR	Red
CASE MATERIAL	ABS & Clear/ PC - Flame Retardant - Rating 94 V0
DIMENSIONS	111.9 (W) x 111.9 (H) x 81.3 (D) mm
WEIGHT	262 g includes back box and fixings
COMPATIBILITY	ALL GFE addressable systems
INSTALLATION	Wall mounting

For EN54-13 compliance, please check the control panel manual specifications.



© 240125

Global Fire Equipment SA

Sítio da Barracha, Parque Industrial Municipal da Barracha, 8150-016 São Brás de Alportel - PORTUGAL

Telephone: (00351) 289 896 560 / Email: info@globalfire-equipment.com / Web: www.globalfire-equipment.com



GSS GROUP

ORDER CODE

GFE-MCPE-AI-IP67

ADD. MANUAL CALL POINT INC. LOOP ISOLATOR, OUTDOOR USE - IP67

1328-CPR-0376
0359-UKCA-CPR-00202

DIMENSIONS

Exploded View

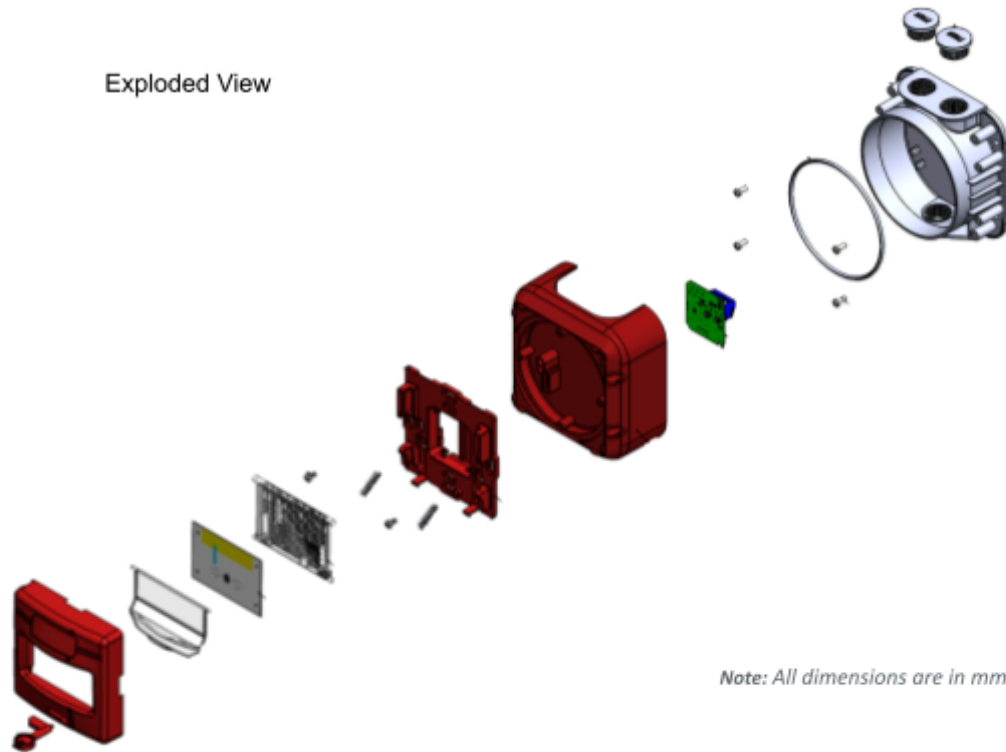

Note: All dimensions are in mm

Front View



Side View

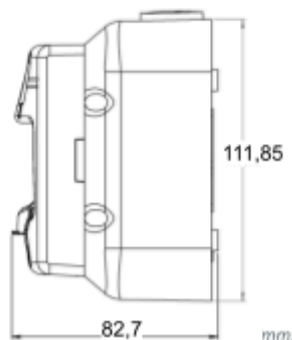

Bottom View

