

PARADOX 

SR230M

Outdoor Siren



INSTALLATION MANUAL

Version - 1.0

Introduction

The SR230M is a stand-alone, fully supervised outdoor wireless siren with a built-in strobe light and wireless transceiver. It uses two-way wireless communication, ensuring continuous supervision between the panel and siren, and delivers rapid response to alarm signals within two seconds. It features the latest Gaussian Frequency Shift Keying (GFSK) technology with frequency and encryption hopping. This ensures superior wireless range, enhanced encryption, supervision, and reliability. The SR230M typically offers lens color options, such as red, blue, and amber.



Quick Installation - Experienced Installers

To install SR230M:

NOTE: Opening the cover (Tamper) will not trigger an audio alarm. The audio alarm will be triggered only if the SR230M is registered to the **Armed** status system. In **Disarmed** status, tamper events—such as cover removal or detachment from the wall—will send a CMS report and a push notification.

1. Open the siren and remove the batteries.
2. Fix the backplate.
3. Insert the batteries.
4. Pair SR230M with the console (Using the BlueEye application):
 - Go to: **Hardware** > Tap **+** on the top-right of the page > **Auto learn devices**.**NOTE:** You can instantly pair SR230M by pressing the **Learn** button, or by opening the tamper.
5. Configure SR230M (Using the BlueEye application):
 - Go to: **Hardware** > Tap **SR230M** from the device list > Enter the necessary details > **Save**.

Built-in status indications of SR230M:

Status LED

- Flashing red 5 times - Power up sequence

LD2

- Red blinking (5 times) - Not connected to the console; the device is defaulted (new or unpaired).
- Green blinking (5 times) - Connected to the console; the device is paired.

- Amber flashing once per second - The device is not synchronized with the panel.
- Red and Green blinking alternately (8 times) - Tamper detected
- Green blinking (8 times) - Tamper resolved

Components of SR230M

The following figure displays the components of SR230M.

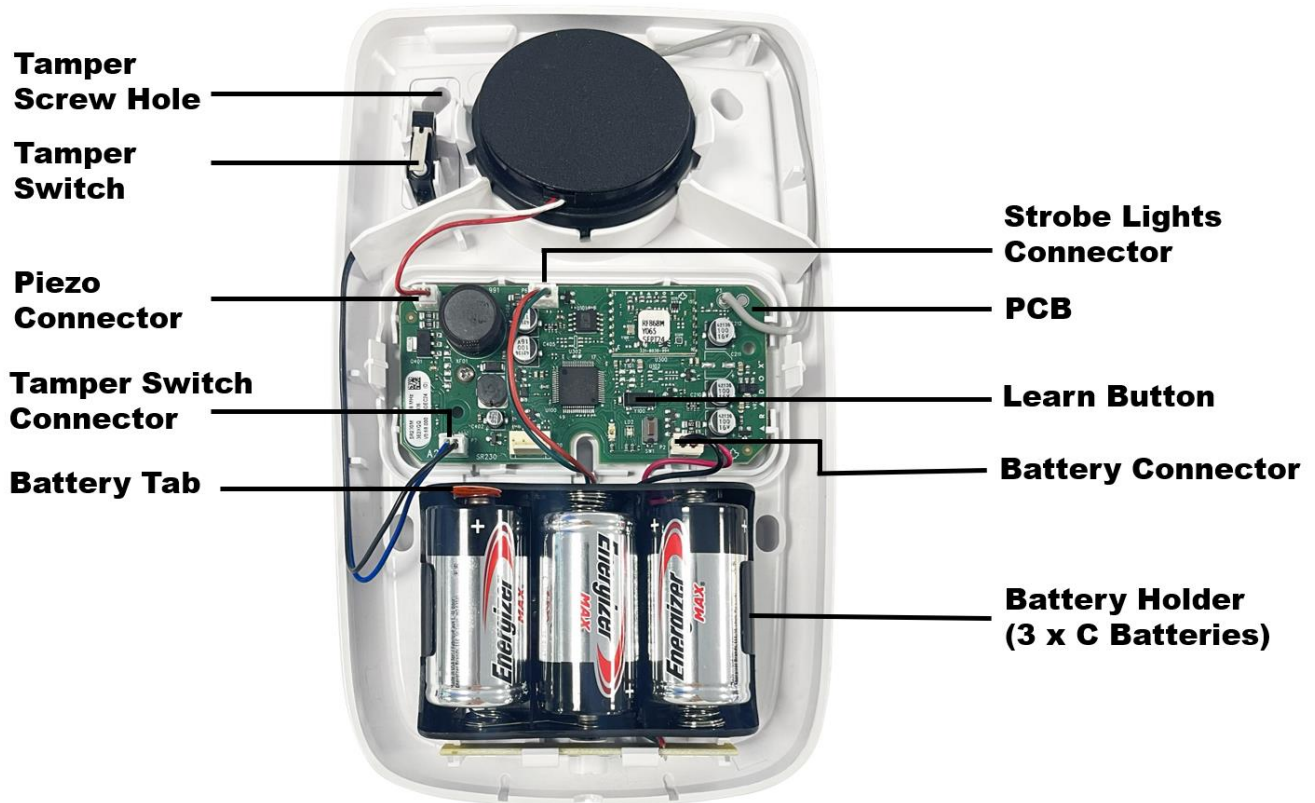

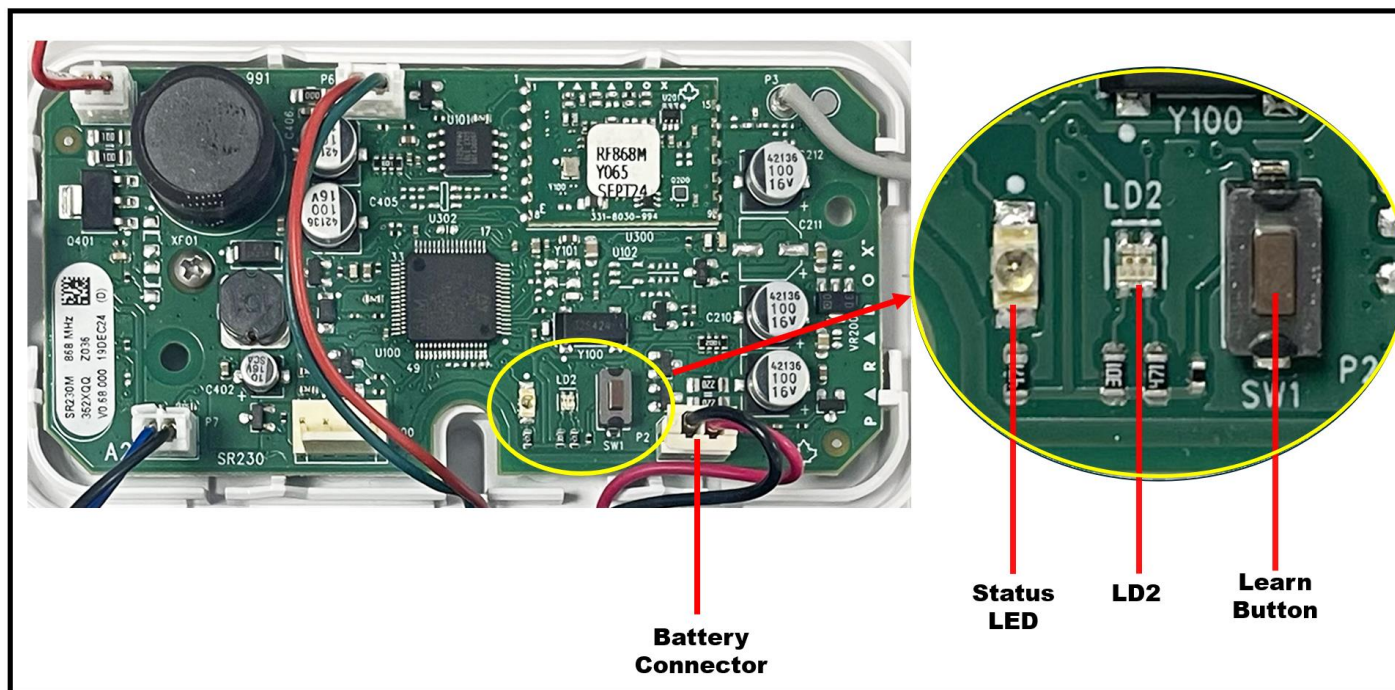

Components of SR230M

Physical Mounting

To mount SR230M:

1. From the bottom of the SR230M, release the screw and lift the front cover.
2. Screw the SR230M siren onto the wall through the four provided holes.
NOTE: As per the EN security standards, one screw must be secured in the tamper hole. The use of double-sided tape does not trigger a wall tamper alarm.
3. Remove the battery tab (present only if the battery is included with the product) from the battery holder. Ensure that the three C Alkaline batteries in the compartment are installed with the correct polarity.
4. Connect **Battery Connector**.
5. Reattach the front cover and tighten it using the screw at the bottom.

Power-up Sequence

During the power-up sequence, the LED will flash five times red if the device is not paired to the console or five times green if paired to the console. The SR230M waits between 0-10 seconds before connecting/pairing with the console. During this time, if the cover is open, green and red LEDs will flash quickly.

Pairing SR230M with the Wireless Console

The pairing and configuration settings of SR230M are managed through the BlueEye application.

Prerequisites

Ensure that:

1. The SR230M is within the range of the console.
2. The BlueEye application is installed on your mobile and connected to the site.
3. The M console is powered on (Paradox logo color - white, red, or green).

Pairing SR230M

To pair the SR230M with the wireless console by an installer:

1. In BlueEye, when in the **Hardware** tab, tap **+** on the top-right of the page, and then tap **Auto learn wireless devices**.
The wireless console searches for new devices and a rotating radar icon is displayed. All unpaired devices pair within 6 minutes and appear at the top of the device list with a **new** tag and voice announcements. You can open the front cover of the siren and press the **Learn** button, or open the tamper for immediate pairing.

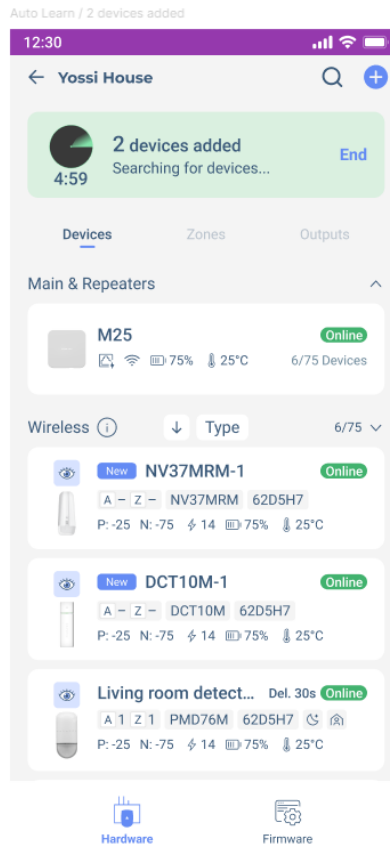

To identify the device that you want to pair, you can trigger the device tamper, and then check the device's screen in the BlueEye application to see the corresponding display. When you trigger the device tamper, a **T** symbol appears on the device name in the BlueEye application.

Pairing Previously Used Devices

You can pair used devices under the following conditions:

- **When the previously used device is not online with another wireless console:** Start auto-learn. Open the cover or press the learn button for immediate pairing, or wait up to 6 minutes for automatic pairing.
- **When the previously used device is online with another wireless console:** Press and hold the **Learn** button for 8 seconds to reset the device to its default settings. Reset will be indicated by LEDs flashing and restarting the device. Start auto-learn.
NOTE: *Ensure the device is not connected or paired with the previous console before resetting the device.*

Configuring SR230M

To configure the SR230M settings:

1. When in the **Hardware** tab, tap **SR230M** from the device list if the device is already paired. If the device is not paired, see the [Pairing SR230M](#) section in this manual and pair the device.
2. On the page that opens, enter the necessary details for the parameters and then tap **Save**.
For details about each parameter displayed on the page, see [Table 1](#).

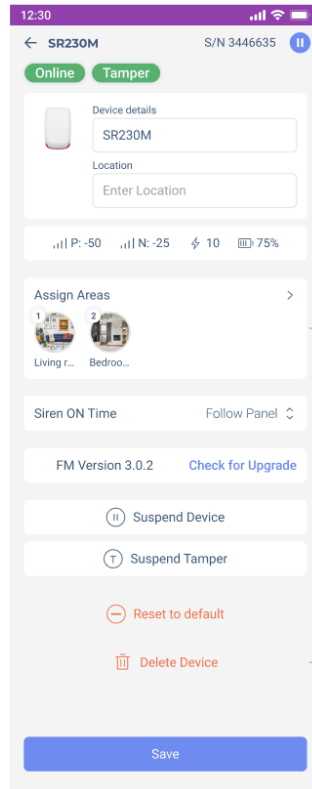

The following table lists the parameters displayed for configuring the SR230M, along with their descriptions.

Table 1

Parameter	Description
Assign areas	Specify the area where the siren will be mounted and assigned for operations.
About	This tab displays details such as the installation date, production date, last programming date, battery replacements, battery history, and upgrade history.
Suspend Device	Disables monitoring of the device in the system.
Reset to Default	This will reset the device to the factory default settings. NOTE: <i>Only an installer can reset the device.</i>
Delete Device	This option deletes the device from the system completely. After deletion, the system generates a push notification only if the owner registration is complete, not during installation. NOTE: <i>Only an installer can delete the device.</i>

LED Indications

After configuring SR230M, the device displays various LED indications based on specific events. The following table lists the LED indications and their corresponding event.

Table 2

LED Indication	Event
Status LED	
Flashing red 5 times	Power up sequence
LD2	

Red blinking (5 times)	Not connected to the console; the device is defaulted (new or unpaired).
Green blinking (5 times)	Connected to the console; the device is paired.
Amber flashing once per second	The device is not synchronized with the panel.
Red and Green blinking alternately (8 times)	Tamper detected
Green blinking (8 times)	Tamper resolved.

Resetting

Press and hold the **Learn** button for 8 seconds to reset the device to its default settings. Reset is indicated by LED flashing red three times.

Upgrading Firmware

To upgrade the firmware:

1. In the **Hardware** tab, tap on the device > **Check for Upgrade**.
2. If an upgrade is available, tap **Upgrade** when prompted.
The process may take a few minutes. Keep track of the progress in the BlueEye application to ensure that the upgrade is completed successfully. Both the Installers and owners can perform the upgrade.

Signal Strength and Transmit Power Monitoring

The BlueEye application provides insights into each device's received signal strength and transmission power to optimize performance.

To view the RSSI and transmit power range:

1. When in the **Hardware** tab, tap the ⓘ icon next to the **Wireless** tab.
A pop-up window with the RSSI and transmit power range is displayed.
2. Maximum power transmitted by SR230M:
 - 868 MHz: +14 dBm
 - 914 MHz: +22 dBm

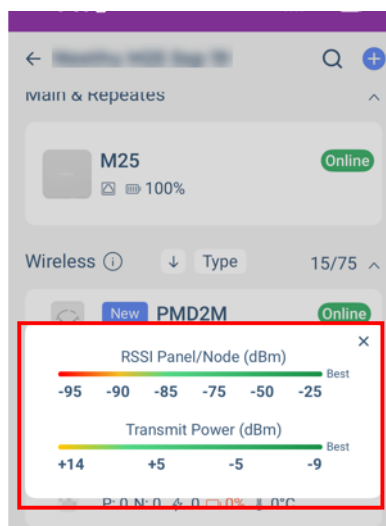

Tap on any listed device to view signal strength and additional device metrics. The following parameters are displayed for each device:

P: -46 N: -18 ⚡ -9 🌡 24°C 🔋 100%

- **P** - Received signal strength at the panel
- **N** - Received signal strength at the device
- ⚡ - Transmit power of the device.
- 🌡 - Current temperature reading of the device.
- 🔋 - Battery level of the device

A higher P and N value indicates stronger and clearer communication between the console and the device.

- If **P** is low, the console struggles to receive signals from the device.
- If **N** is low, the device struggles to receive signals from the console.

NOTE: *Values below -93 with maximum Tx power are not recommended values, and RPT5M can be used to extend the range.*

Power transmission impacts only **P**:

- When **power transmission** increases, the **P** value at the console generally improves, as a stronger signal is sent.
- If **P** value is good, the device can reduce its transmission power to save battery life.

Alarm Signaling

When triggered by a human intrusion or system tamper while armed, the SR230M makes a loud siren and flashes its strobe light to alert its owner or user.

The SR230M communicates with the main security panel or console using two-way wireless signals, allowing it to send status updates and receive commands from the panel. This feature ensures the system stays informed of the siren's operational status, battery level, and tamper conditions.

Dual Tamper Protection

The SR230M is equipped with dual tamper protection (wall and cover). If the system is armed, any tamper activation immediately triggers a system alarm. When the system is disarmed, a tamper activation generates a report to the CMS, sends a push notification, and displays a tamper trouble alert in the BlueEye application.

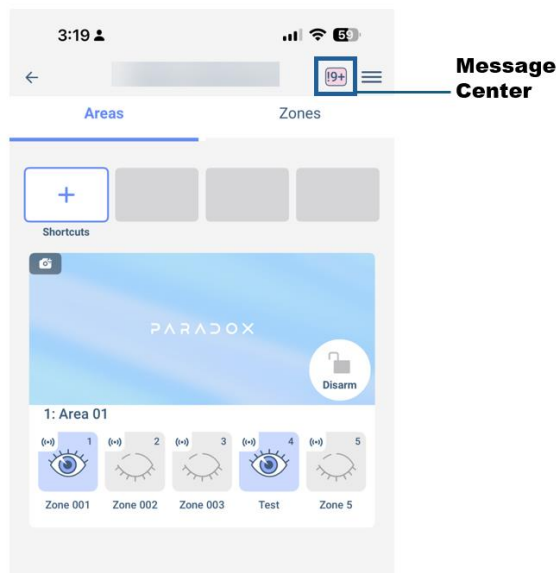

Technical Specifications

The following table lists the technical specifications of SR230M along with their descriptions.

NOTE: *The specifications are subject to change without prior notice.*

Table 3

Specification	Description
Current Consumption	Standby: 5.75 μ A, Maximum: 450 mA
Wireless type	GFSK two-way with frequency and encryption hopping
RF Frequency	868 (865.05 - 867.95) MHz or 914 (902.25 - 927.55) MHz Other countries might change
RF power	868 MHz up to +14 dBm radiated, 914 MHz up to +22 dBm in permitted countries.
Status Indicators	Battery, temperature, TX/RX values
Battery Alkaline	3 x 1.5 VDC C, up to 5 years of battery life**
Siren	100 dBA or more (1 meter)
Transmission Time	Less than 20 ms
Supervision Time	20 minutes, 10 minutes (Default), and 3 minutes
Installation Environment	Outdoor
Firmware Upgrade	Remotely over the air, via BlueEye
IP Rating	IP54
Operating Temperature	-20°C to +40°C (-4°F to 104°F)
Auto Learn	Yes
Colors	White
Weight	0.55 kg
Dimensions	13.43W x 21.17H x 5.1D cm (5.29W x 8.34H x 2.01D in.)
Certification	CE, EN 50131-4, EN 50131-6, EN 50131-5-3, FCC 15.247

**It is recommended to replace alkaline batteries after four years due to the risk of leakage.

FCC Statements

This device complies with Part 15 of the FCC Rules. Operation is subject to the following two conditions:

1. This device may not cause harmful interference, and
2. This device must accept any interference received, including interference that may cause undesired operation.

Changes or modifications not expressly approved by the party responsible for compliance could void the user's authority to operate this equipment.

NOTE: This equipment has been tested and found to comply with the limits for a Class B digital device, pursuant to part 15 of the FCC Rules. These limits are designed to provide reasonable protection against harmful interference in a residential installation. This equipment generates, uses, and can radiate radio frequency energy and, if not installed and used in accordance with the instructions, may cause harmful interference to radio communications. However, there is no guarantee that interference will not occur in a particular installation.

If this equipment does cause harmful interference to radio or television reception, which can be determined by turning the equipment off and on, the user is encouraged to try to correct the interference by one or more of the following measures:

1. Reorient or relocate the receiving antenna.
2. Increase the separation between the equipment and the receiver.
3. Connect the equipment into an outlet on a circuit different from that to which the receiver is connected.
4. Consult the dealer or an experienced radio/TV technician for help.

WARNING – RF EXPOSURE COMPLIANCE: This equipment should be installed and operated with a minimum distance 20cm between the radiator and your body.

FCC ID: KDYSR230M
IC: 2438A-SR230M

- This Class B digital apparatus complies with Canadian ICES-003.

IC Statements

This device contains licence-exempt transmitter(s)/receiver(s) that comply with Innovation, Science and Economic Development Canada's licence-exempt RSS(s). Operation is subject to the following two conditions:

1. This device may not cause interference.
2. This device must accept any interference, including interference that may cause undesired operation of the device.

Warranty

For complete warranty information on this product, see the [Limited Warranty Statement](#) document, or contact your local Paradox distributor.

Patents

US, Canadian, and international patents may apply. Paradox is a trademark or registered trademark of Paradox Security Systems (Bahamas) Ltd.

© 2025 Paradox Security Systems (Bahamas) Ltd. All rights reserved.